

ITEM	DESCRIPTION	COLOR	QTY
①	WS-003D, APPROVAL : VDE	BLACK	1
②	WS-002F, APPROVAL : VDE	BLACK	1
③	H05VV-F 3G 1.50MM ² , APPROVAL : VDE, FI, D, N, S, SEV, SAA	BLACK	1
④	CABLE TIE		1

TOLERANCES	UNIT	RoHS COMPLIANT		PART NO.	EK519.2,5
±0.25	mm	REF: K080829E-2.5M		TITLE: IEC CORD WITH IEC320-C20 & IEC320-C19 H05VV-F3G 1.5MMSQ CABLE 2.5M BLACK	

(MARKING)



CABLE OD SIZE:
 ϕ 6.7 ϕ 7.0 ϕ 8.5

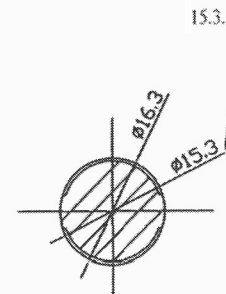
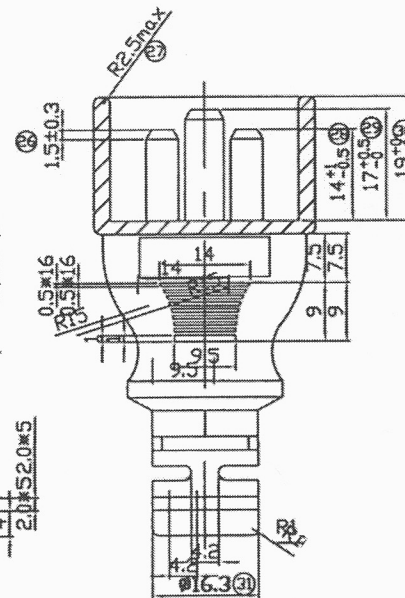
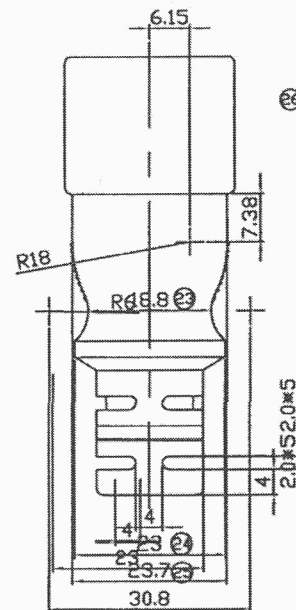
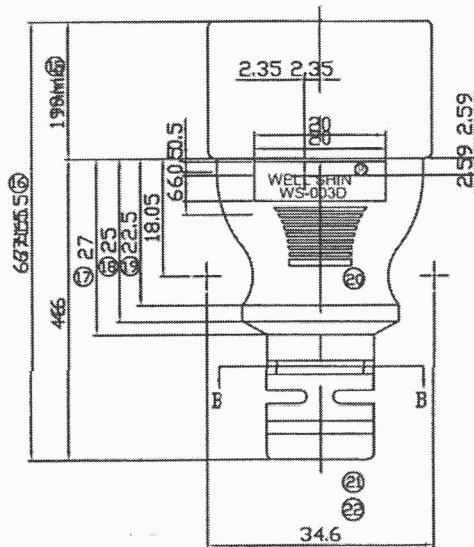
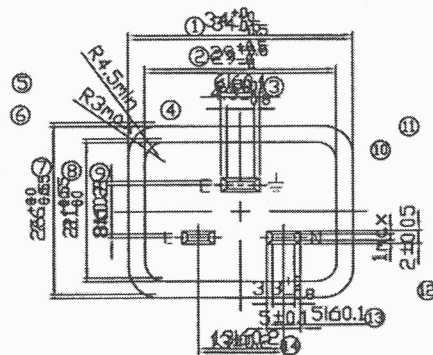
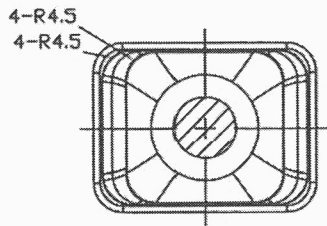

B-B SECTION

0~5	±0.2
5~15	±0.3
15~30	±0.5
30~100	±0.8
100~300	±1.0
300~1000	±1.2
1000~	±2

DIMENSIONS ARE IN MILLIMETERS				RoHS COMPLIANT	
TOLERANCE UNLESS OTHERWISE SPECIFIED		PART NO.	WS-003D		TITLE: IEC320-C20 CONNECTOR VDE APPROVED
LINEAR	0.0±0.25	DATE	SEPTEMBER / 19 / 2008		
	0.00±0.15				
ANGLES	± 3	NOT SCALED DRAWING		DRAWING NO.	WS-003D

