

VE802

HDMI HDBaseT-Lite Extender with POH

- The VE802 HDMI HDBaseT-Lite Extender extends an HDBaseT signal up to 70m from the HDBaseT source using one Cat 5e/6/6a cable. VE802 supports RS-232 and IR signaling pass-through, allowing you to control the HDMI source device from the remote unit (VE802R) while also granting access to the HDMI display device from the local unit (VE802T). IR signals can also be extended in both directions. The VE802 features Power over HDBaseT (POH) which can send power over Cat 5e/6/6a cable without an additional power supply. The VE802 is HDMI (3D, Deep Color, 4k) and HDCP compatible. The VE802 is perfect for a digital entertainment center or any installation that requires superior video quality.



HDMI™ HIGH DEFINITION MULTIMEDIA INTERFACE

HDBaseT™ AHD



Features

- HDBaseT Connectivity – extends an HDMI connection over a long distance via one Cat 5e/6/6a cable
- HDBaseT Anti-jamming – resists signal interference during high-quality video transmission using HDBaseT technology
- [EDID Expert – configures optimum EDID settings for smooth power-up, high-quality display and use of the best resolution across different screens](#)
- POH (Power over HDBaseT) – supplies power from Transmitter to Receiver over a long distance via one Cat 5e/6/6a cable
- Bi-directional RS-232 serial port for control and configuration
- Bi-directional IR channel for IR signal control; IR transmission is processed one way at a time
- Rack- Mountable

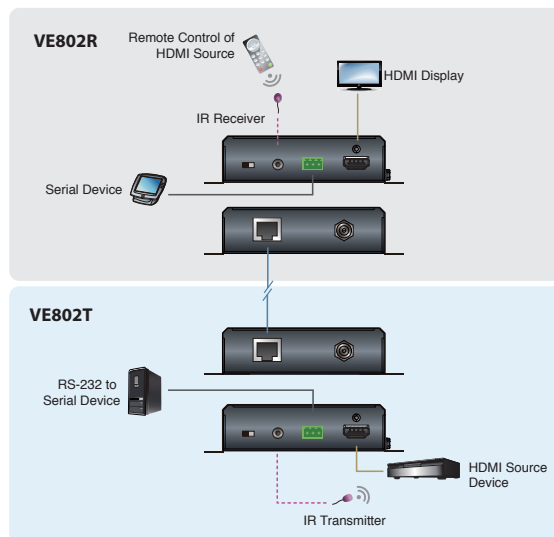

Specification

Function		VE802
Video Input	Interface	1 x HDMI Type A Female (Black)
	Impedance	100Ω
	Max distance	1.8 m
Video Output	Interface	1 x HDMI Type A Female (Black)
	Impedance	100Ω
	Max. data rate	10.2Gbps (3.4Gbps per lane)
Video	Max. pixel clock	340 MHz
	Compliance	HDMI (3D, Deep Color, 4K) HDCP Compatible Consumer Electronics Control (CEC)
	Max resolutions / Distance	Up to 4K@35m (Cat 5e/6) / 40m (Cat 6a); 1080p@60m (Cat 5e/6) / 70m (Cat 6a)
	Audio	Input: 1 x HDMI Type A Female (Black) Output: 1 x HDMI Type A Female (Black)
Control	Connector	1 x Terminal Block, 3 pole
	Baud rate and protocol	Baud Rate: 19200, Data Bits:8, Stop Bits:1, no parity and flow control
	IR	1 x Mini Stereo Jack Female (Black)
Power	Connector	1 x DC Jack (Black) with locking
	Consumption	VE802T: DC5V, 3.6W; VE802R: DC5V, 4W
Environment	Operating Temp.	0–50°C
	Storage Temp.	–20–60°C
	Humidity	0–80% RH, Non-condensing
Physical Properties	Housing	Metal
	Weight	VE802T: 0.44 kg VE802R: 0.46 kg
	Dimensions (L x W x H)	14.48 x 12.30 x 3.00 cm

